

## Pre-Incident Plans

*Pre-Incident Plans are different than Fire Safety Plans and require the drawing format to be Fire Fighter specific. To ensure that your Pre-Incident Plan is properly formatted, please read the information detailed below and view the samples provided.*

The Pitt Meadows Fire & Rescue Service now requires Pre-Incident Plans (PIP) to be submitted with the Fire Safety Plan. The PIP is Fire Fighter specific and includes all life safety symbols, except fire extinguishers and pull stations. Pre-Incident Plans assist the Incident Commander in making quick, precise decisions based on vital information located on a well-designed Fire Safety Plan. Pre-Incident Plans aid responding personnel in effectively managing an emergency with available resources while fully understanding the hazards at the specific location.

***NFPA 1620: Recommended Practice for Pre-Incident Planning*** is the National Fire Protection Association standard outlining the recommended practice for developing pre-incident plans. NFPA 1620 defines a pre-incident plan as a document developed by gathering general and detailed data (pre-incident plans) used by responding personnel to determine the resources and actions necessary to mitigate anticipated emergencies at specific facilities.

The samples below show the same site plan and the same floor plan, one with extinguishers and pull stations (Fire Safety Plan Drawing) and one without (Pre-Incident Plan Drawing).

# Fire Safety Plan Drawing (Site Plan)

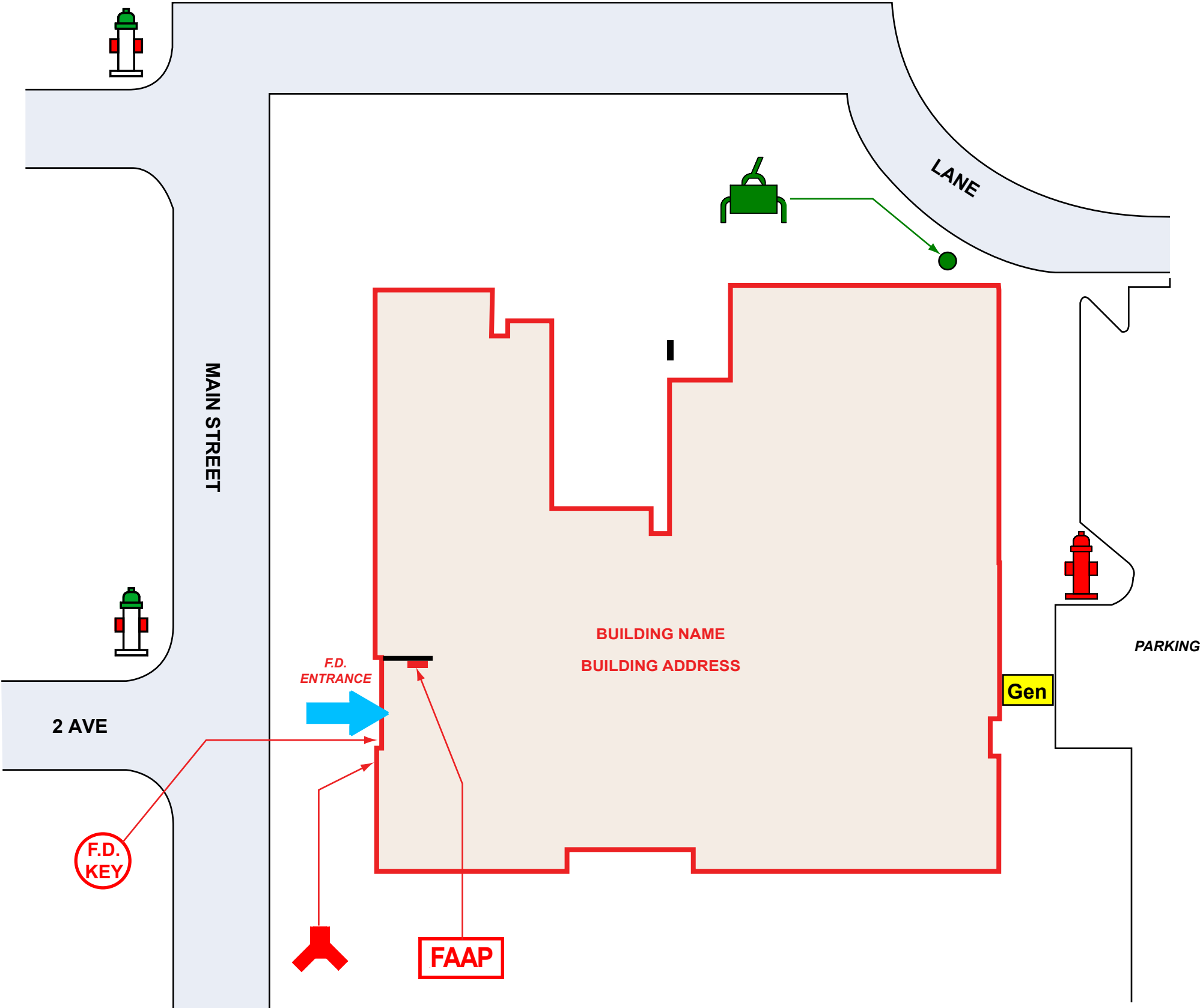

LEGEND	
	FIRE ALARM ANNUNCIATOR
	FIRE DEPARTMENT CONNECTION
	GAS SHUT-OFF
	PUBLIC HYDRANT
	PRIVATE HYDRANT
	GENERATOR



**Site Plan  
Fire Safety Plan**

**Pre-Incident Plan Drawing (Site Plan)**

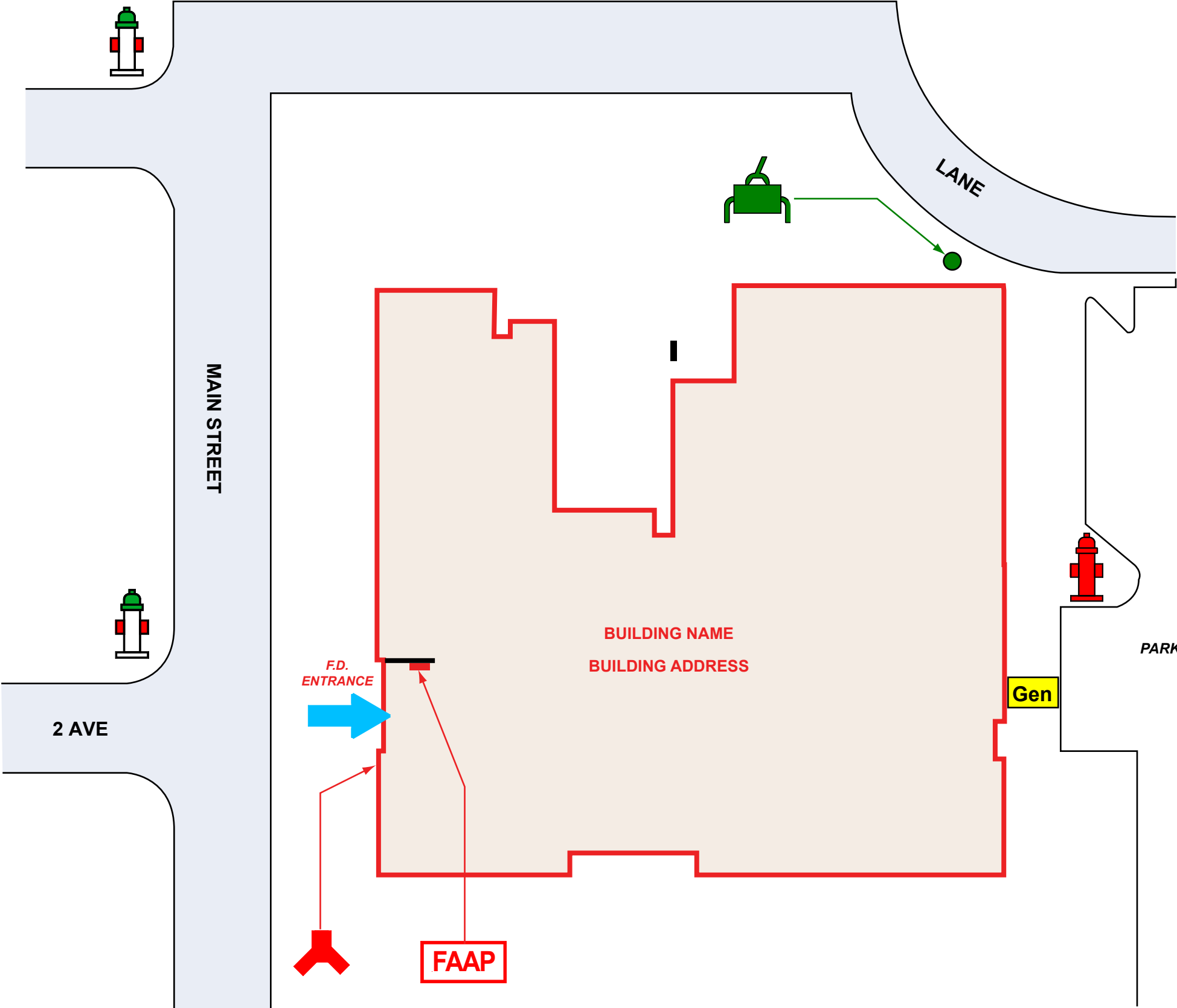

LEGEND	
	FIRE ALARM ANNUNCIATOR
	FIRE DEPARTMENT CONNECTION
	GAS SHUT-OFF
	PUBLIC HYDRANT
	PRIVATE HYDRANT
	GENERATOR













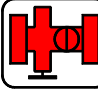
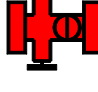

**Site Plan  
Pre-Incident Planning**



# Pre-Incident Plan Drawing (Floor Plan)

Notice how this drawing is simplified from the previous, and only contains vital information which is useful to the fire fighter.

LEGEND	
	FIRE ALARM ANNUNCIATOR
	FIRE ALARM CONTROL PANEL
	STANDPIPE CONNECTION
	SPRINKLER CONTROL VALVES
	FLOOR ISOLATION VALVE
	WATER CURTAIN
	FIRE HOSE IN CABINET
	ELECTRICAL ROOM/VAULT
	ELECTRICAL HAZARD
	FIREFIGHTER ELEVATOR- FULL
	FIREFIGHTER ELEV.- CONVERTED
	PULL STATION FOR SUPPRESSION SYSTEM
	DOMESTIC WATER SHUT-OFF
	HAZARD



Floor Plan  
Pre-Incident Planning